

The following slides showing progress toward Bond projects were presented to the Berkley Schools Board of Education on August 10, 2015 by Stantec.

**The drawings and proposed designs represented in this presentation are in draft form, and may be altered before final construction.**

“Children are likely to live up to what you believe of them.”

Lady Bird Johnson

## **Berkley School District**

2015 Bond Projects

Board of Education Update

# Team Introductions

# Project Schedule

## 2015 Bond Program

Project	2015												2016												2017												2018																								
	J	F	M	A	M	J	J	A	S	O	N	D	J	F	M	A	M	J	J	A	S	O	N	D	J	F	M	A	M	J	J	A	S	O	N	D	J	F	M	A	M	J	J	A	S	O	N	D													
Pre Pricing						■	■	■	■																																																				
Bid Pack #1 Angell Elementary						■	■	■	■	■	■	■	■	■	■	■	■	■	■	■	■	■	■	■																																					
Bid Pack #1 Pattengill Elementary						■	■	■	■	■	■	■	■	■	■	■	■	■	■	■	■	■	■	■																																					
Bid Pack #2 Norup International School						■	■	■	■	■	■	■	■	■	■	■	■	■	■	■	■	■	■	■																																					
Bid Pack #3 Berkley High						■	■	■	■	■	■	■	■	■	■	■	■	■	■	■	■	■	■	■	■	■	■	■	■	■	■	■	■	■	■	■	■																								
Bid Pack #4 Burton Elementary													■	■	■	■	■	■	■	■	■	■	■	■	■	■	■	■	■	■	■	■	■	■	■	■																									
Bid Pack #4 Rogers Elementary													■	■	■	■	■	■	■	■	■	■	■	■	■	■	■	■	■	■	■	■	■	■	■	■																									
Bid Pack #5 Anderson Middle School													■	■	■	■	■	■	■	■	■	■	■	■	■	■	■	■	■	■	■	■	■	■	■	■																									
Bid Pack #6 Tyndall																									■	■	■	■	■	■	■	■	■	■	■	■	■	■	■	■	■	■	■	■	■	■	■	■													
Bid Pack #7 Avery Center																									■	■	■	■	■	■	■	■	■	■	■	■	■	■	■	■	■	■	■	■	■	■	■	■													



Denotes Design



Denotes Construction Phase



Denotes Bidding and Award



Denotes Shop Drawings and Material Order



# Where We've Been

# Schematic Design Process

- **Weekly Admin Team Planning Meetings**
- **Develop “Pre-pricing” plan**
- **BFacC Check-in**
- **Building / Design Team Meetings Project Introduction**
- **50% SD Check-In**
- **100% SD Review**
- **Release Angell, Pattengill, Norup and BHS to McCarthy & Smith for Estimating**



# Equipment Pre-Pricing



# Equipment Pre Pricing

## Pre Pricing Scope of Work-All Buildings

### -Boilers

- Fire Alarm Equipment
- Vertical Unit Ventilators
- Building Automation Controls

## Benefits of Pre Pricing

- Standardize major systems in every building
- District has more say in equipment selection
- Competitive pricing from economy of scale
- Material procurement and delivery



# Plans + Images

# Angell Elementary School

## COLOR LEGEND

- ACADEMIC
- ACADEMIC SUPPORT
- ADMINISTRATION
- ADMINISTRATION SUPPORT
- FINE ARTS
- FINE ARTS SUPPORT
- FOOD SERVICE
- FOOD SERVICE SUPPORT
- PHYSICAL ED/ATHLETIC
- PHYSICAL ED/ATHLETIC SUPPORT
- CIRCULATION
- RESTROOMS
- CUSTODIAL/MECHANICAL/IT

## First Level



## Second Level

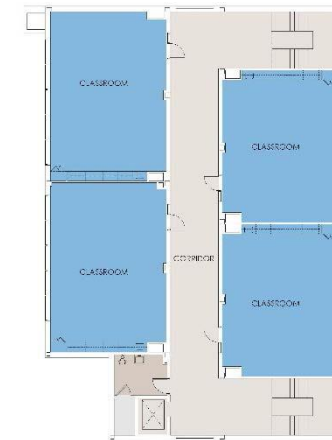

Overall Plans



# Art Room Addition

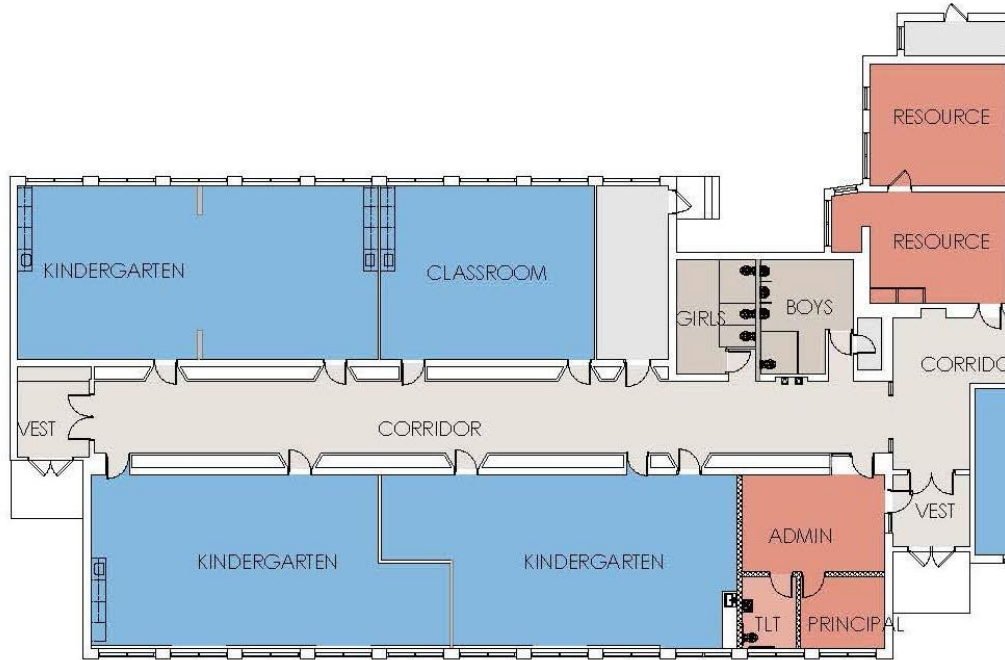
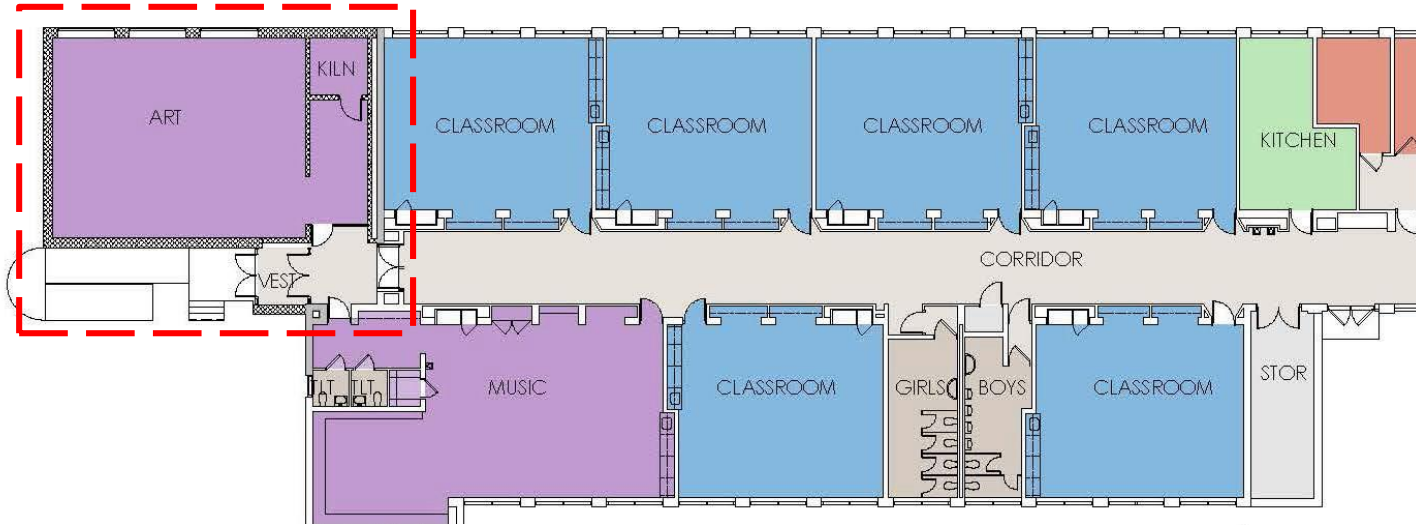

Kindergarten Suite

## COLOR LEGEND

- ACADEMIC
- ACADEMIC SUPPORT
- ADMINISTRATION
- ADMINISTRATION SUPPORT
- FINE ARTS
- FINE ARTS SUPPORT
- FOOD SERVICE
- FOOD SERVICE SUPPORT
- PHYSICAL ED/ATHLETIC
- PHYSICAL ED/ATHLETIC SUPPORT
- CIRCULATION
- RESTROOMS
- CUSTODIAL/MECHANICAL/IT







Three-Dimensional Perspectives





# Pattengill Elementary School

**COLOR LEGEND**

- ACADEMIC
- ACADEMIC SUPPORT
- ADMINISTRATION
- ADMINISTRATION SUPPORT
- FINE ARTS
- FINE ARTS SUPPORT
- FOOD SERVICE
- FOOD SERVICE SUPPORT
- PHYSICAL ED/ATHLETIC
- PHYSICAL ED/ATHLETIC SUPPORT
- CIRCULATION
- RESTROOMS
- CUSTODIAL/MECHANICAL/IT

First Level













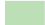

Second Level

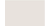

# New Front Office / Secure Entry



## COLOR LEGEND

- |   |                        |   |                              |
|---|------------------------|---|------------------------------|
|   | ACADEMIC               |   | FOOD SERVICE SUPPORT         |
|  | ACADEMIC SUPPORT       |  | PHYSICAL ED/ATHLETIC         |
|  | ADMINISTRATION         |  | PHYSICAL ED/ATHLETIC SUPPORT |
|  | ADMINISTRATION SUPPORT |  | CIRCULATION                  |
|  | FINE ARTS              |  | RESTROOMS                    |
|  | FINE ARTS SUPPORT      |  | CUSTODIAL/MECHANICAL/IT      |
|  | FOOD SERVICE           |   |                              |







Three-Dimensional Perspectives





# Norup International School

**COLOR LEGEND**

- ACADEMIC
- ACADEMIC SUPPORT
- ADMINISTRATION
- ADMINISTRATION SUPPORT
- FINE ARTS
- FINE ARTS SUPPORT
- FOOD SERVICE
- FOOD SERVICE SUPPORT
- PHYSICAL ED/ATHLETIC
- PHYSICAL ED/ATHLETIC SUPPORT
- CIRCULATION
- RESTROOMS
- CUSTODIAL/MECHANICAL/IT

First Level



Second Level

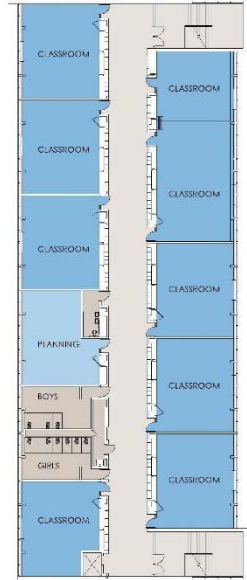

Overall Plans



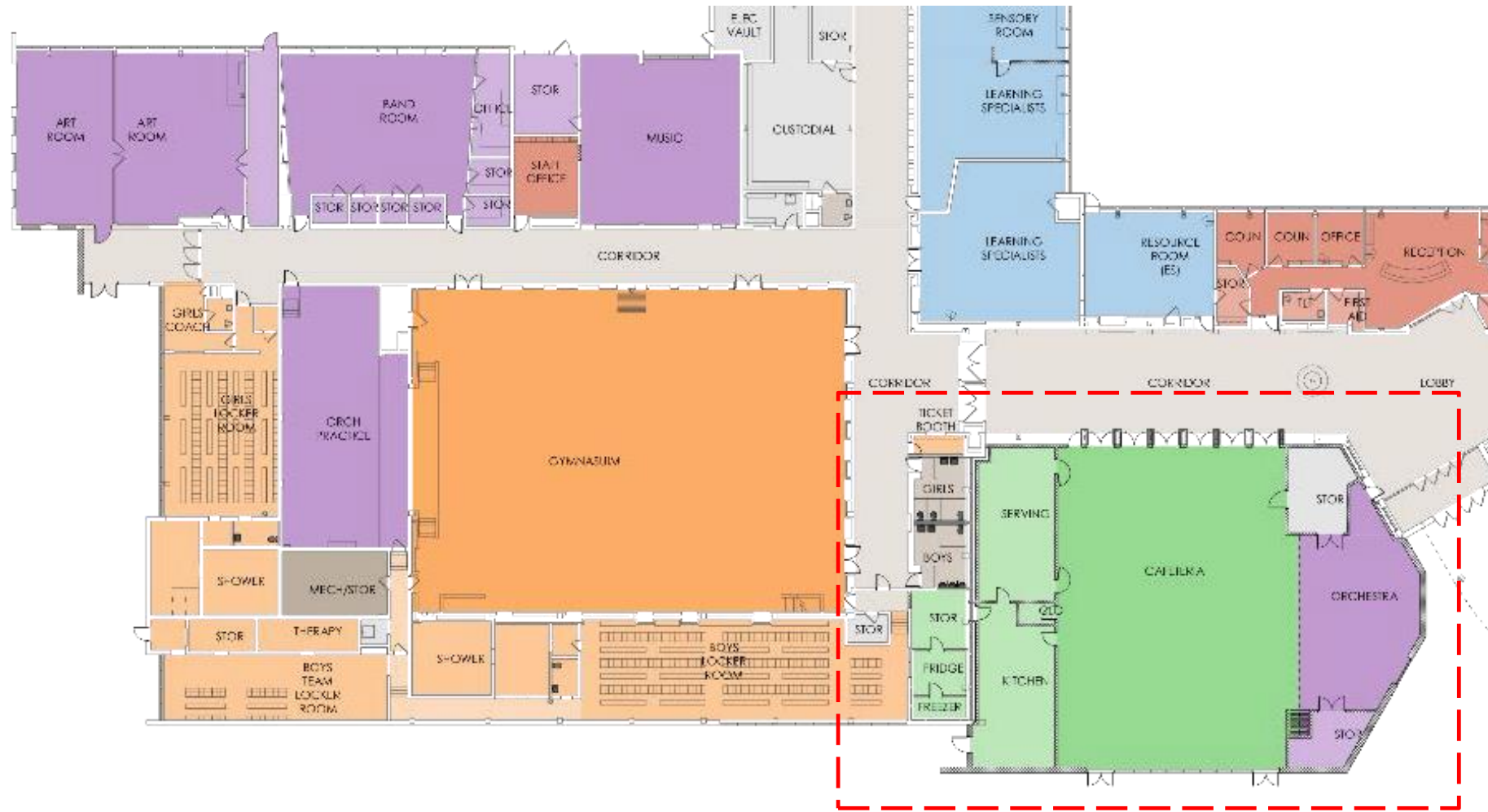

**COLOR LEGEND**

- ACADEMIC
- ACADEMIC SUPPORT
- ADMINISTRATION
- ADMINISTRATION SUPPORT
- FINE ARTS
- FINE ARTS SUPPORT
- FOOD SERVICE
- FOOD SERVICE SUPPORT
- PHYSICAL ED/ATHLETIC
- PHYSICAL ED/ATHLETIC SUPPORT
- CIRCULATION
- RESTROOMS
- CUSTODIAL/MECHANICAL/IT

New Cafetorium Addition







Three Dimensional Perspectives





# Berkley High School

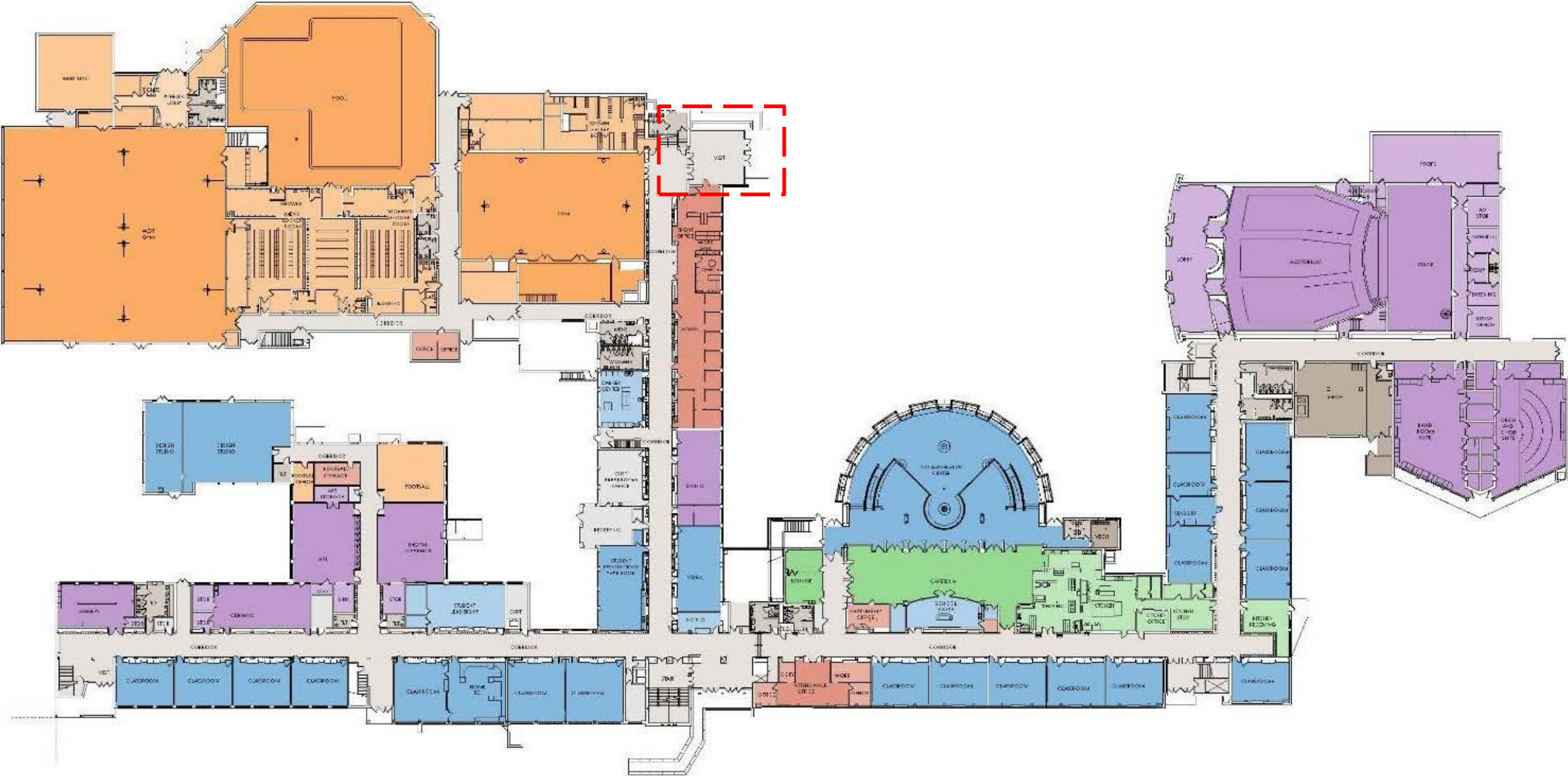

**COLOR LEGEND**

- ACADEMIC
- ACADEMIC SUPPORT
- ADMINISTRATION
- ADMINISTRATION SUPPORT
- FINE ARTS
- FINE ARTS SUPPORT
- FOOD SERVICE
- FOOD SERVICE SUPPORT
- PHYSICAL ED/ATHLETIC
- PHYSICAL ED/ATHLETIC SUPPORT
- CIRCULATION
- RESTROOMS
- CUSTODIAL/MECHANICAL/IT

Overall Plan – First Level



**COLOR LEGEND**

- ACADEMIC
- ACADEMIC SUPPORT
- ADMINISTRATION
- ADMINISTRATION SUPPORT
- FINE ARTS
- FINE ARTS SUPPORT
- FOOD SERVICE
- FOOD SERVICE SUPPORT
- PHYSICAL ED/ATHLETIC
- PHYSICAL ED/ATHLETIC SUPPORT
- CIRCULATION
- RESTROOMS
- CUSTODIAL/MECHANICAL/IT

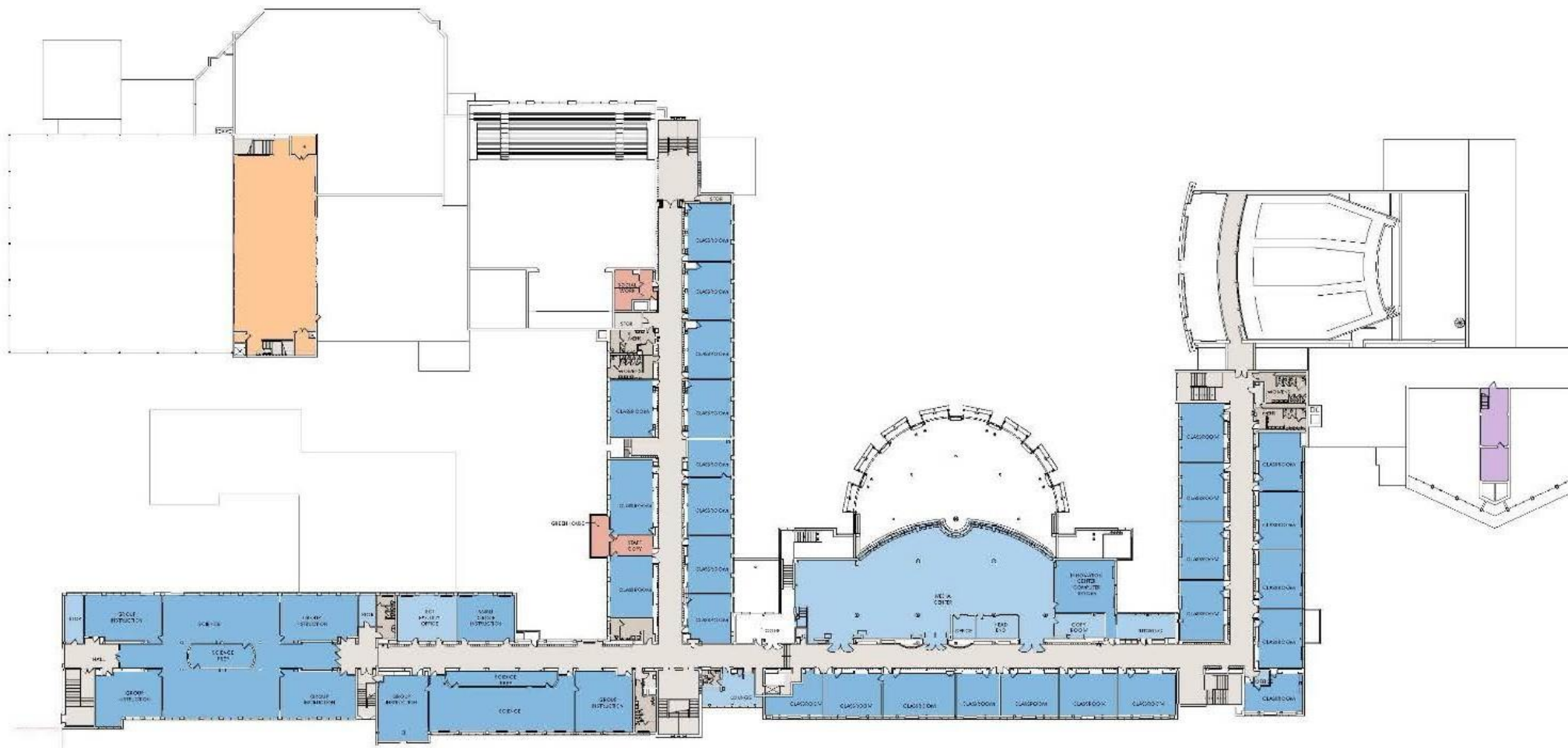

Overall Plan – Second Level



**COLOR LEGEND**

- |   |   |
|---|---|
| <span style="color: #4F81BD;">■</span> ACADEMIC               | <span style="color: #90EE90;">■</span> FOOD SERVICE SUPPORT         |
| <span style="color: #ADD8E6;">■</span> ACADEMIC SUPPORT       | <span style="color: #FF8C00;">■</span> PHYSICAL ED/ATHLETIC         |
| <span style="color: #D2691E;">■</span> ADMINISTRATION         | <span style="color: #FFDAB9;">■</span> PHYSICAL ED/ATHLETIC SUPPORT |
| <span style="color: #E9967A;">■</span> ADMINISTRATION SUPPORT | <span style="color: #D3D3D3;">■</span> CIRCULATION                  |
| <span style="color: #800080;">■</span> FINE ARTS              | <span style="color: #A9A9A9;">■</span> RESTROOMS                    |
| <span style="color: #DDA0DD;">■</span> FINE ARTS SUPPORT      | <span style="color: #808080;">■</span> CUSTODIAL/MECHANICAL/IT      |
| <span style="color: #32CD32;">■</span> FOOD SERVICE           |   |



Enlarged Plan – Design Center

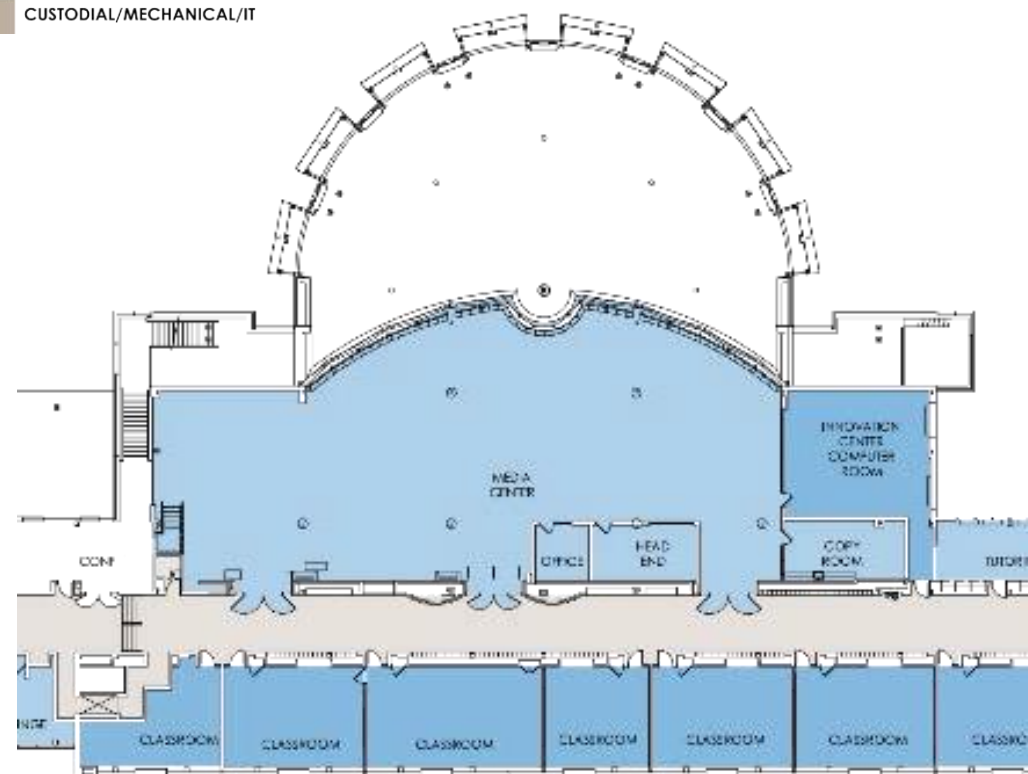

Enlarged Plan – Media Center







Three Dimensional Perspectives



# Technology Deployment



## **Anderson (To be complete by Fall 2016)**

New Phone System/Voice mail

New Network Electronics (Switches)

Updated Wireless (Mobile Computing)

Note that the following systems will be added during the renovation phase of the building (to be complete Fall 2017):

- New Classroom & Office Cabling
- New Card Access System with lock-down
- New Secure Door Buzzers
- New IP-based surveillance system and cameras
- New Audio / Video system (Sound Fields, Video Projectors)

## **Angell (To be complete by Fall 2016)**

New Phone System/Voice mail

New Network Electronics (Switches)

Wireless / Access Points for Mobile Computing

New Classroom & Office Cabling

New Card Access System with Lock Down

New Secure Door Buzzers

New IP based surveillance system and cameras

New Audio / Video system ( Sound Fields, Video Projectors)



## **Avery (To be complete by Fall 2016)**

New Phone System/Voice mail

New Network Electronics (Switches)

New Card Access with Lock-Down

Note that the following systems will be added during the renovation phase of the building (to be complete Fall 2018):

- New IP-based surveillance system and cameras
- Updated Wireless

## **Berkley High School (To be complete by Fall 2016)**

New Sound System in Performing Arts Auditorium (2015)

New Phone System/Voice mail

New Network Electronics (Switches)

Wireless / Access Points for Mobile Computing

New Classroom & Office Cabling

New Card Access System with Lock Down

New Secure Door Buzzers

New IP based surveillance system and cameras

New Audio / Video system ( Sound Fields, Video Projectors)



### **Burton (To be complete by Fall 2016)**

New Phone System/Voice mail

New Network Electronics (Switches)

Wireless / Access Points for Mobile Computing

Note that the following systems will be added during the renovation phase of the building (to be complete Fall 2017):

- New Classroom & Office Cabling
- New Card Access System with lock-down
- New Secure Door Buzzers
- New IP-based surveillance system and cameras
- New Audio / Video system (Sound Fields, Video Projectors)

### **Norup (To be complete by Fall 2016)**

New Phone System/Voice mail

New Network Electronics (Switches)

Wireless / Access Points for Mobile Computing

New Classroom & Office Cabling

New Card Access System with Lock Down

New Secure Door Buzzers

New IP based surveillance system and cameras

New Audio / Video system ( Sound Fields, Video Projectors)



### **Pattengill (To be complete by Fall 2016)**

New Phone System/Voice mail

New Network Electronics (Switches)

Wireless / Access Points for Mobile Computing

New Classroom & Office Cabling

New Card Access System with Lock Down

New Secure Door Buzzers

New IP based surveillance system and cameras

New Audio / Supplement Video system (Sound Fields, Video Projectors)

Note: Existing Epson 595wi Projectors will remain and new Video projectors will be provided in remaining classrooms

### **Rogers (To be complete by Fall 2016)**

New Phone System/ Voice mail

New Network Electronics (Switches)

Wireless / Access Points for Mobile Computing

Note that the following systems will be added during the renovation phase of the building (to be complete Winter 2017):

- New Classroom & Office Cabling
- New Card Access System with lock-down
- New Secure Door Buzzers
- New IP-based surveillance system and cameras
- New Audio / Video system (Sound Fields, Video Projectors)



## Tyndall (To be complete by Fall 2016)

New Phone System/ Voice mail

New Network Electronics (Switches)

Note that the following systems will be added during the renovation phase of the building (to be complete Fall 2018):

- New Classroom & Office Cabling
- New Card Access System with lock-down
- New Secure Door Buzzers
- New IP-based surveillance system and cameras
- New Audio / Video system (Sound Fields, Video Projectors)



# Technology Systems and Strategies



Access Control

Surveillance

Maintenance

CPTED

Crime Prevention Through Environmental Design











Peterson







May 2, 2012  
Lesson II  
The 1830s  
Aspects of the Texas Revolution

The Texas Revolution  
The Texas Revolution was a conflict between the state of Texas and the Republic of Texas, which was then a part of Mexico. The revolution began in 1835 and ended in 1836. The Texas Revolution was a significant event in the history of Texas and the United States.



thank you